

# ZAZA2 PLS3

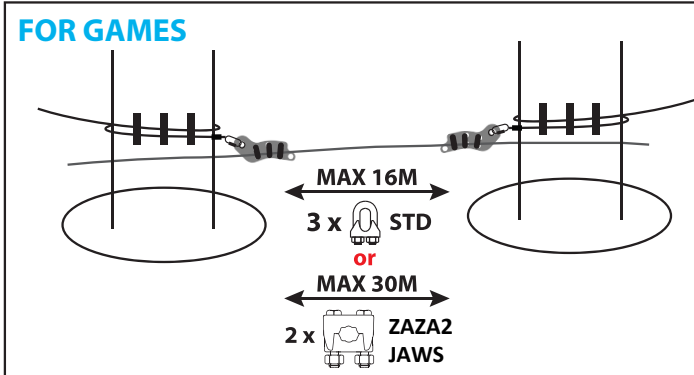

## ADVANTAGE

Easy to install ALL TYPE COURSE

**kN**  
CT/WLL 10kN

**SAFETY CABLE**  
STEEL  
Ø 12  
or 1/2"  
Metal Core

**ADAPTABLE**  
STD 12  
or  
ZAZA2 JAWS

**STANDARDS**  
EN 15567-1  
EN 13411-1/7

**STAINLESS STEEL**  
INOX 316 L

X1  
**ZAZA2 PLS 3**

=

X1  
GO 10/LO 7/16  
CT/WLL 1000KG

**ADAPTABLE**  
3X STD 12  
or  
2X ZAZA2 JAWS

**GUIDING PLATE**  
STAINLESS  
**MANDATORY!**

**NO! Zipline**

### FIXATION EXAMPLE

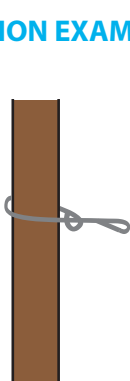

### ROUND TEXTILE SLING TYPE "E"

STANDARDS: EN 13411-1/7

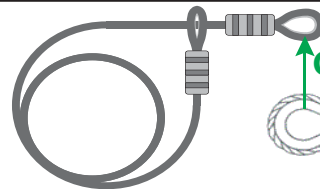
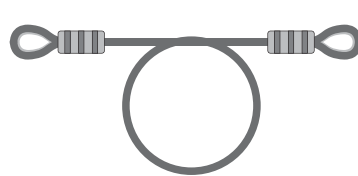

CABLES Ø12 or 1/2"  
**OK! METAL CORE**

Chain Ø 8/10  
Grade 80 mini

STD 12 = 25 Nm

BG12 = 45 Nm

**CRIMPER**

x130 kN

EN15567-1  
EN13411-3  
STANDARDS  
ACCT

**Operation 1**

OK

X1 GO10-LO7/16"

**STANDARDS OF ASSEMBLY**



EN 15567-1  
EN 13411-1/7  
STANDARDS - ACCT

**Operation 2**

x3

STD 12 = EN 13411-5

MANDATORY GUIDING PLATE !

**Operation 2 BIS**



OIL

STD 12 = 25 Nm

2X ZAZA2 JAWS =

= 45 Nm

Same assembly direction

= OK!

MANDATORY GUIDING PLATE !

**Operation 3**

STARTING PLATE

**STANDARDS OF ASSEMBLY**



EN 15567-1:2015  
EN 13411-1/7  
STANDARDS - ACCT

# OBSERVE FITTING ORIENTATION OF BG CLAMPS

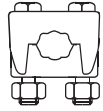

ZAZA2 JAWS

= OBSERVE THE DIRECTION OF CIRCULATION OF THE SAFETY HOOK

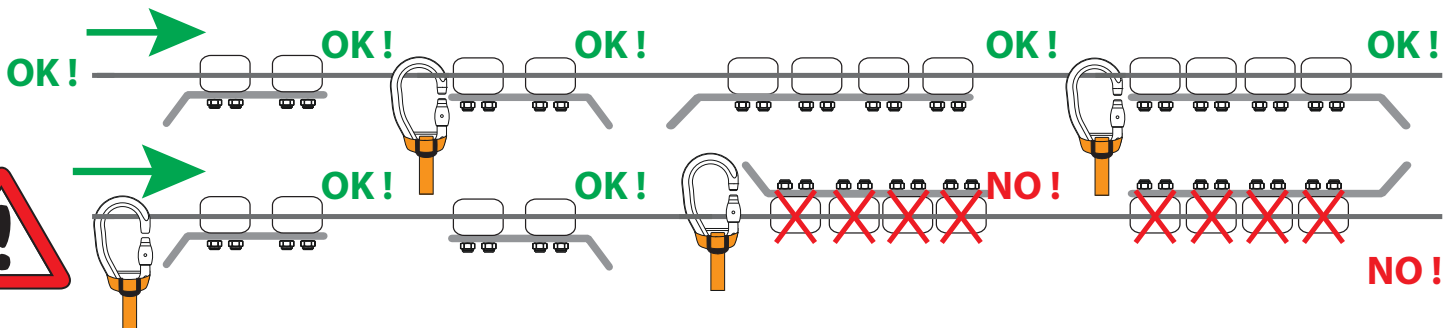
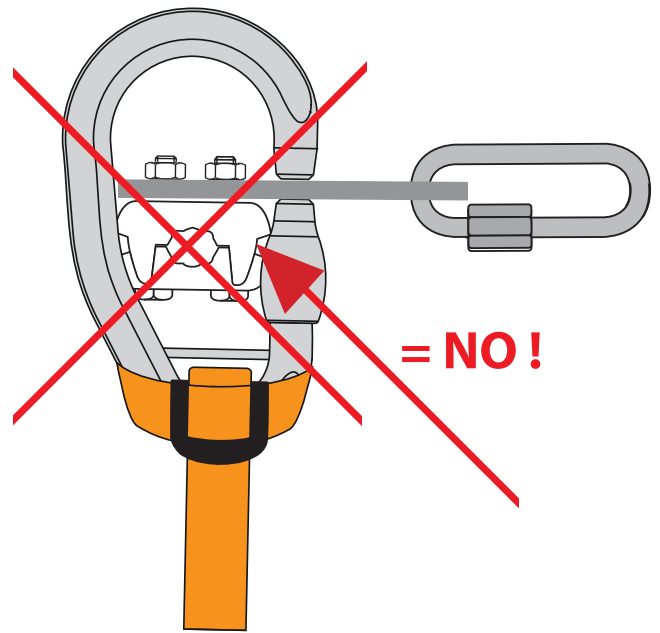
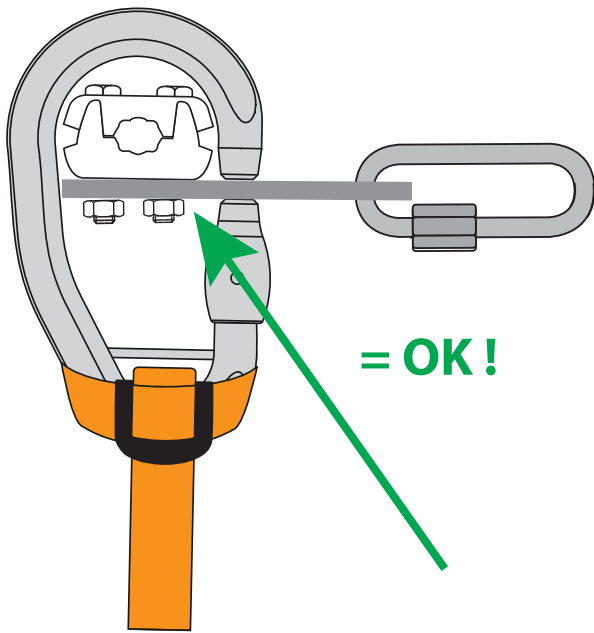
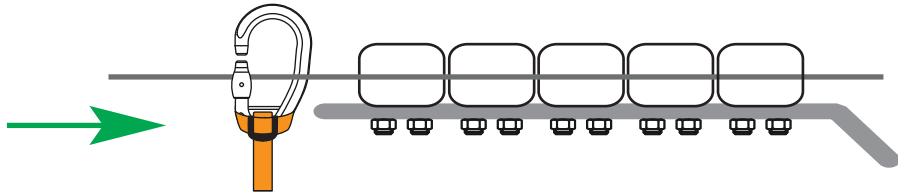

**Operation 4**

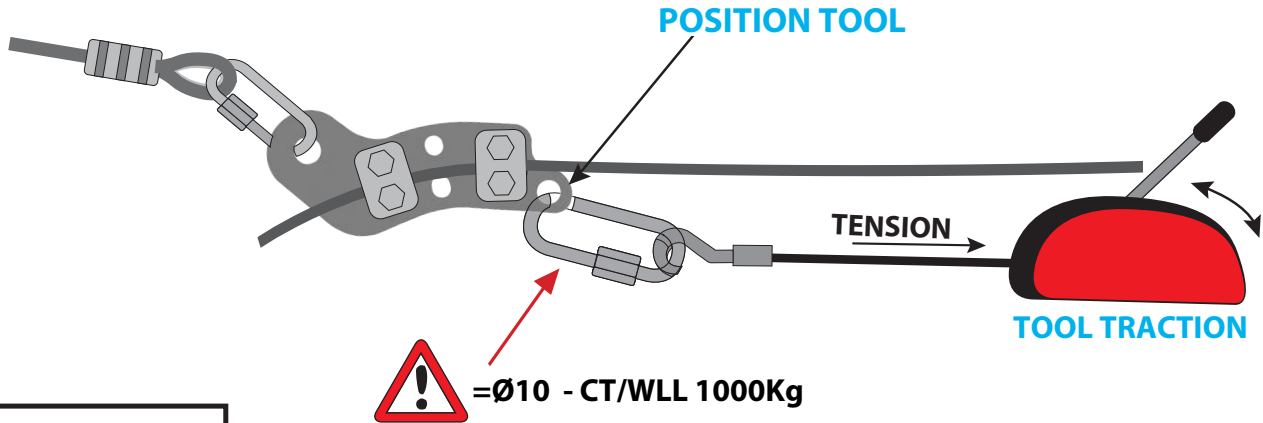

**Operation 5**

● **RECOMMENDATION ASSEMBLY**

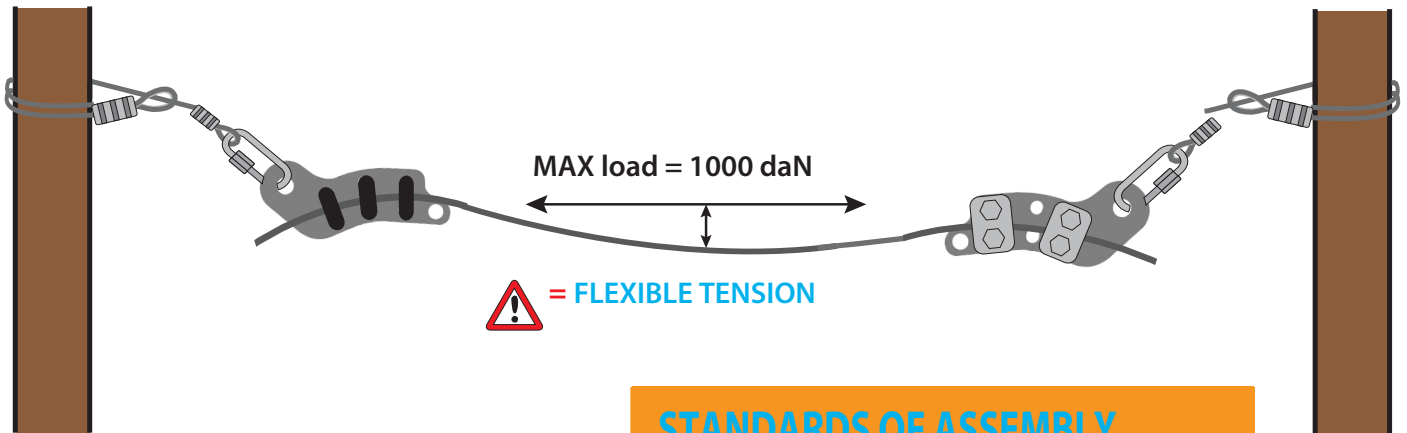

**STANDARDS OF ASSEMBLY**



EN 15567-1  
EN 13411-1/7  
STANDARDS - ACCT

**Operation 6**

● **JUNCTION JUNCTION**

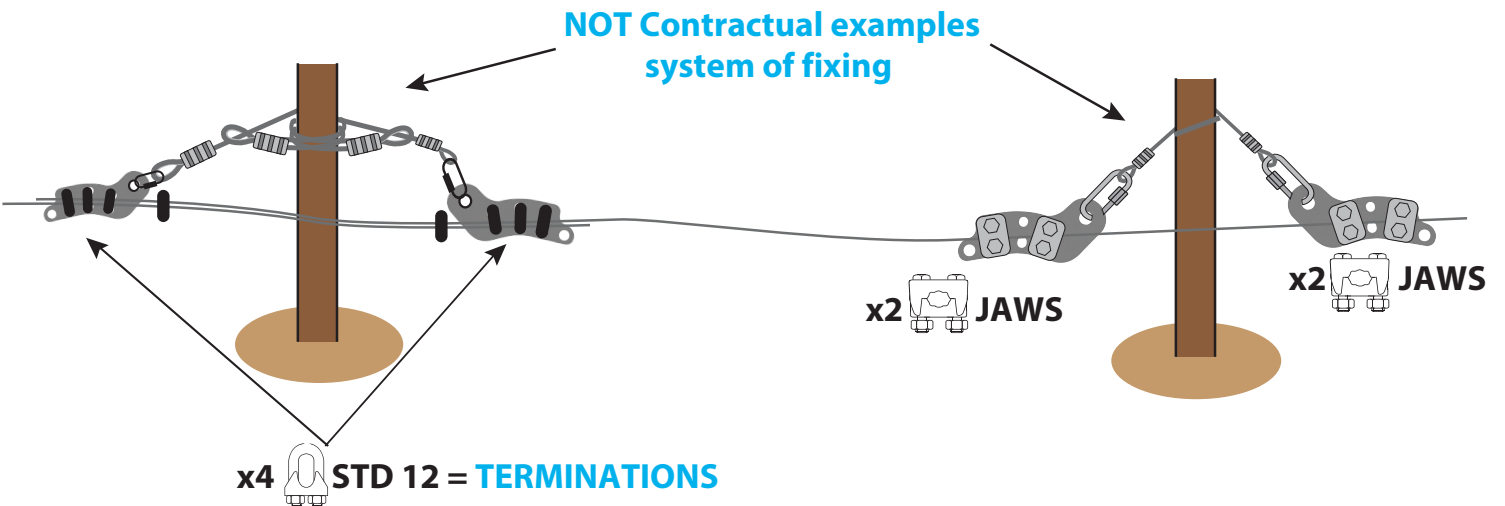

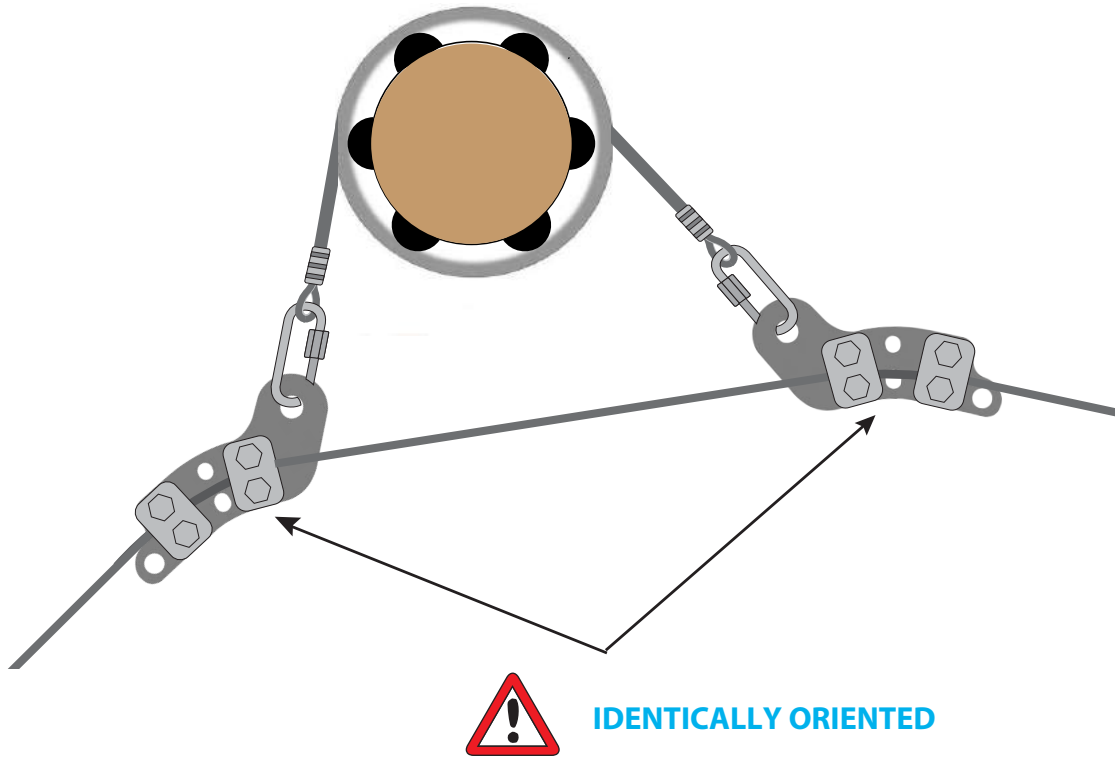

**Operation 7**

**Assembly for rolling games**

