

ZAZA2 DELTA

For games only

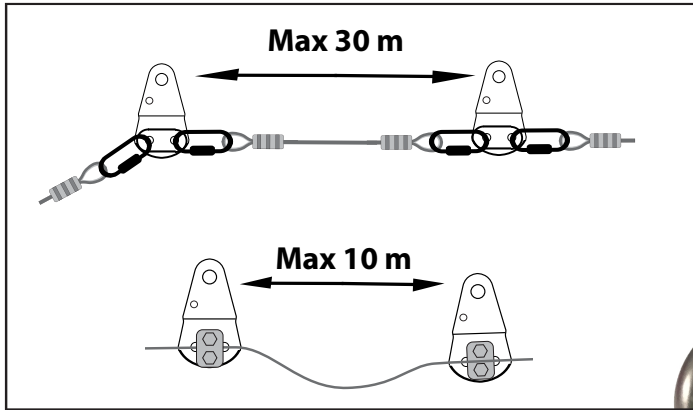

ADVANTAGES:

- SPECIAL FOR ARTIFICIAL STRUCTURE
- REALIZE BENDS OF 0° to 270°
- FLEXIBILITY

kN
CT/WLL 10kN

Security cable
STEEL

Ø 12
or 1/2"
METAL CORE

ADAPTABLE

GO/LO 10
OPTION

ZAZA2
JAWS

STANDARDS
EN 15567-1

STANDARDS

STAINLESS
STEEL

INOX 316L

X1 =

GO 10
LO 7/16"
X2 WLL:1000KG

OR

OPTION

X1 ZAZA2
JAWS

X2
= A2 : M10x20
INOX A2

GO 10
LO 7/16
WLL:1000KG

OR

HR 2T
HS 1/2"

NO! Zipline

EXAMPLE OF FIXING SYSTEM

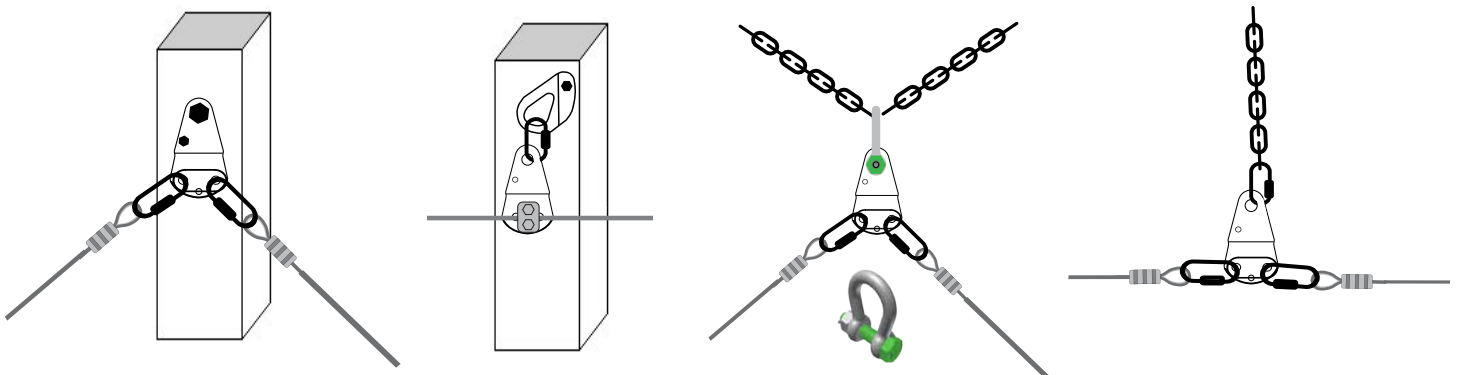

Opération 1

METHOD OF ATTACHMENT

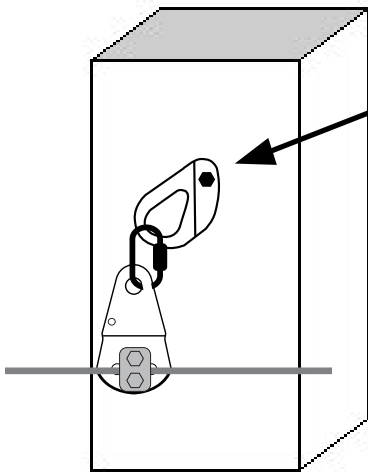
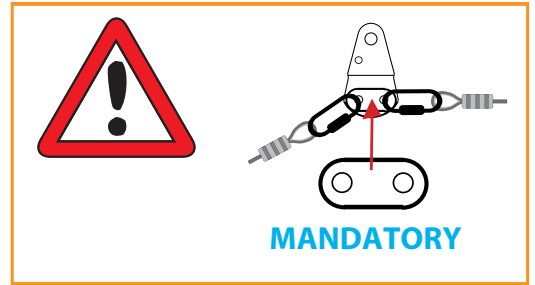
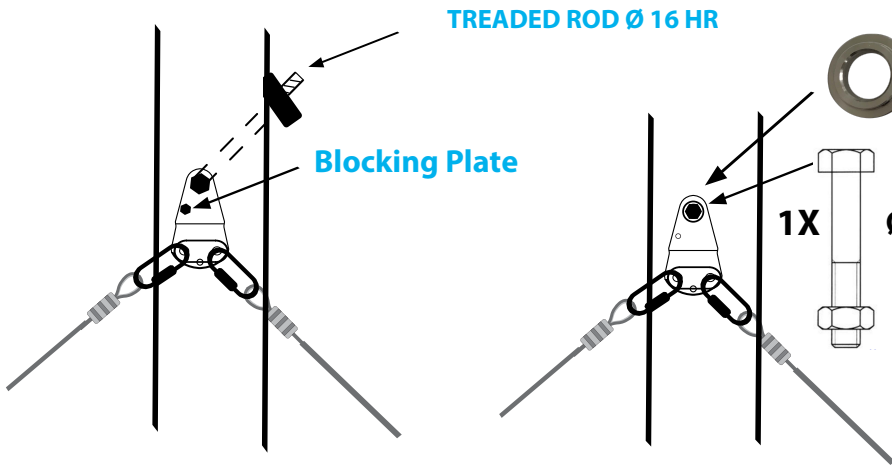

1X Quick link LO 7/16 or 1/2"
WLL:1000KG

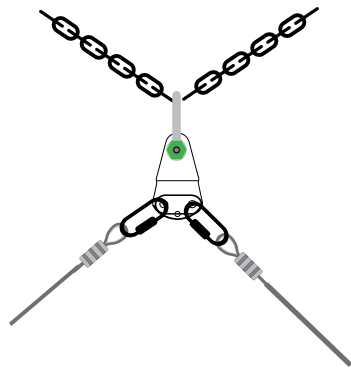

x 1 HR 2T HS 1/2"

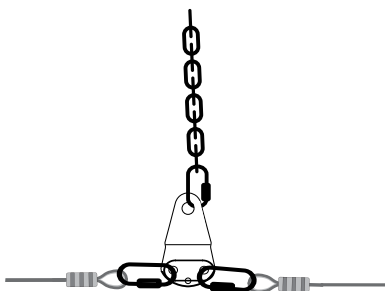
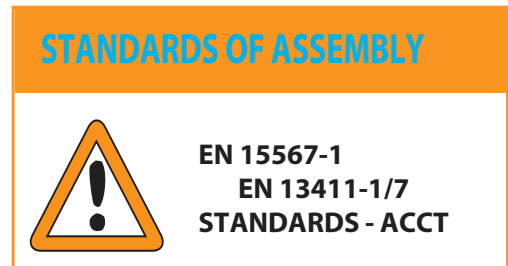

1X Quick link LO 10 or 7/16 or 1/2"
WLL:1000KG

Opération 2

Starting/Arrival Plate

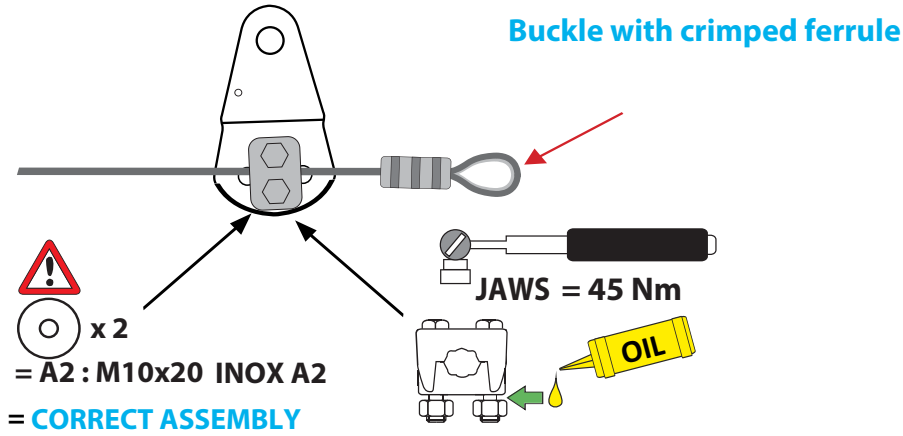

STANDARDS OF ASSEMBLY



EN 15567-1
EN 13411-1/7
STANDARDS - ACCT

Examples of centralized departures

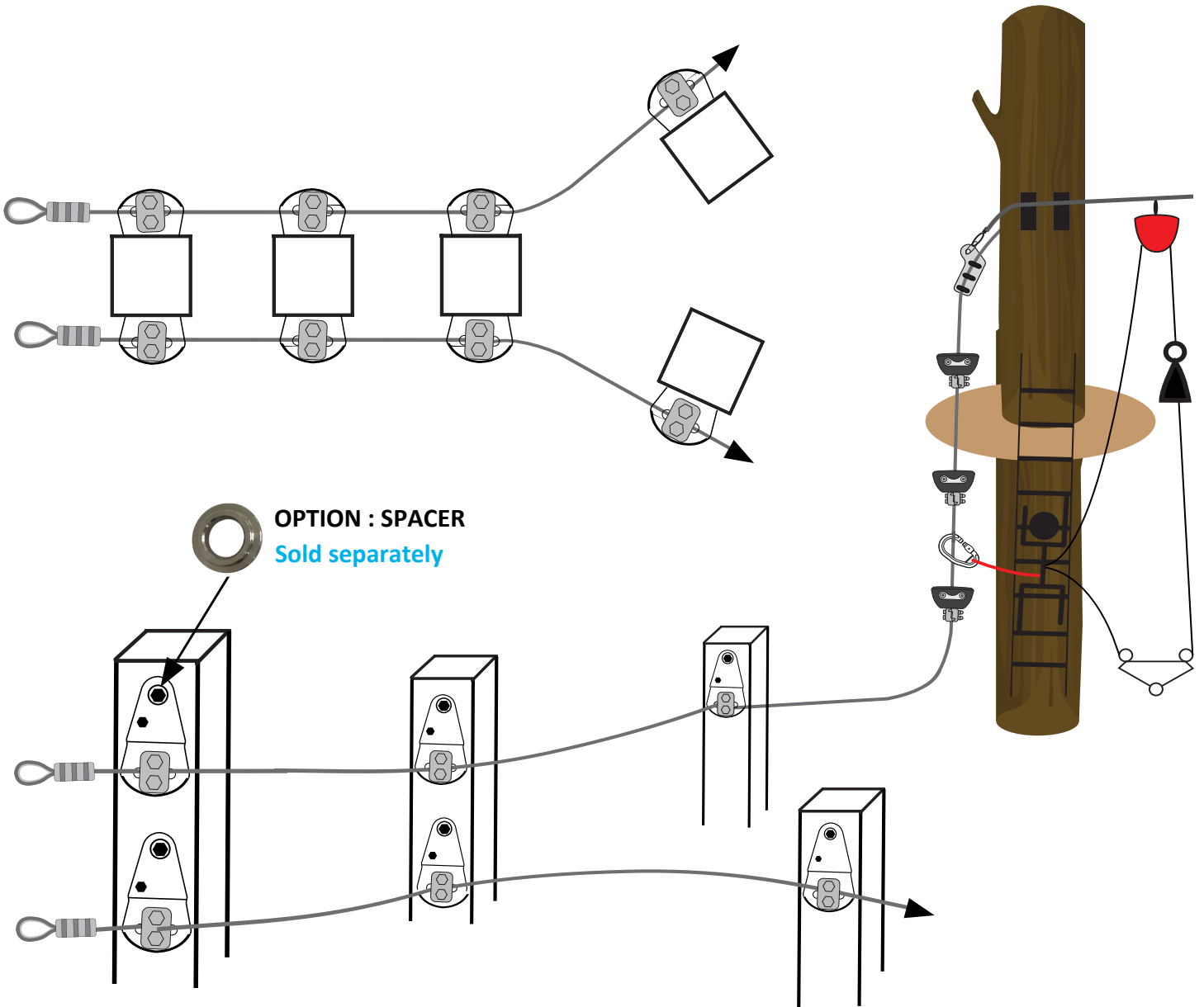

Opération 3

Examples of Combination to Assembly

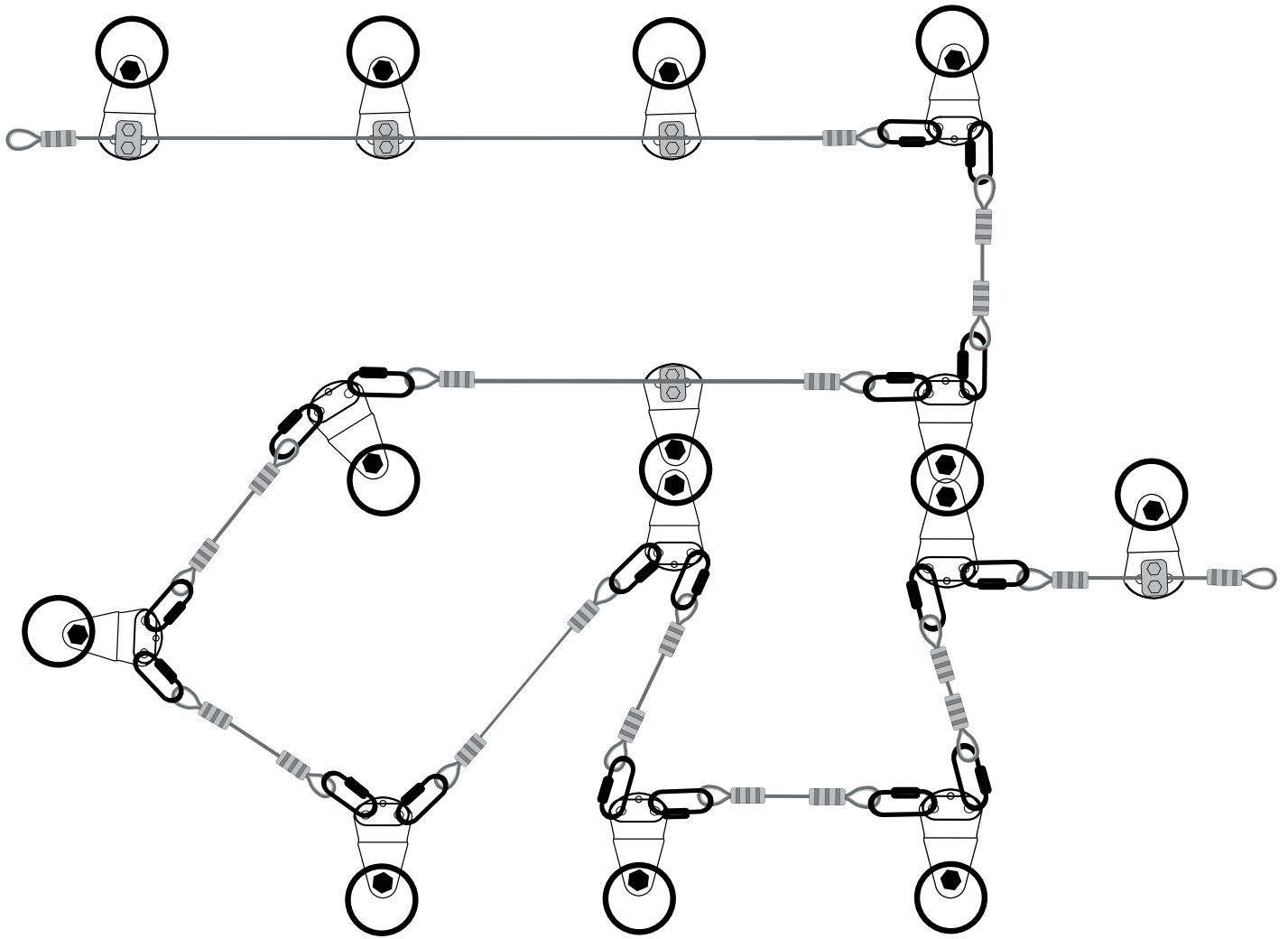

Opération 4

RECOMMENDATION ASSEMBLY

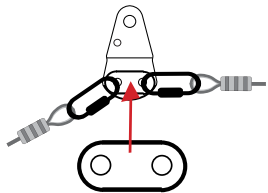

MANDATORY

STANDARDS OF ASSEMBLY



EN 15567-1
EN 13411-1/7
STANDARDS - ACCT

